

## DX 54 Spike

### HIGHLIGHTING AND ILLUMINATING SPACES

The Dx projector family stands out for its extraordinary versatility, thanks to a range of accessories that make it ideal for various applications. Dx projectors are suitable for installations on solid surfaces, such as floors, ceilings, and walls, as well as for ground installations using stakes.

Made from high-quality aluminum, turned, anodized, and painted with a diffusing glass fixed with silicone adhesive to ensure IP protection, they are equipped with power LEDs.

Their adjustability, combined with low-luminance lighting and refined finishes, guarantees excellent aesthetic and functional performance in any setting.

Both the 38 mm and 54 mm models can be used as projectors, by directly attaching the bracket or available in the versions with a stem.

The DX 38 is the smallest spot projector, powered by 24V low voltage, and is available in 3 different heights (60 mm, 160 mm, 500 mm) for installation on solid surfaces with a base, or in the ground with the spike version. It is also offered with an integrated power supply in the specific version with a base (92x59 mm).

The DX54 is available in the 24V version or with an integrated 220-240V power supply and in 3 heights (70 mm, 170 mm, 510 mm); for installation on solid surfaces with the version with a base or on the ground with the spike version.

*La famiglia di proiettori Dx si distingue per la sua straordinaria versatilità, grazie a una gamma di accessori che la rende ideale per diverse applicazioni.*

*I proiettori Dx sono adatti per installazioni su superfici solide, come pavimenti, soffitti e pareti, oltre che per installazioni a terra grazie all'uso del picchetto.*

*Realizzato in alluminio di primaria qualità, tornito, anodizzato e verniciato con vetro diffusore fissato con collante silconico a garantirne la tenuta IP, equipaggiato da power led.*

*La loro orientabilità, combinata con un'illuminazione a bassa luminanza e le raffinate finiture, garantisce un'eccellente resa estetica e funzionale in qualsiasi contesto. Sia il modello 38mm che il 54mm sono utilizzabili come proiettore, fissando direttamente la staffa oppure disponibili nelle versioni su stelo.*

*DX 38 è lo spot più piccolo, alimentato 24V bassa tensione è disponibile in 3 altezze differenti (h.60mm, h.160mm, h.500mm) per installazione su superfici solide nella versione con basetta o nel terreno per la versione con picchetto.*

*Proposto anche con alimentatore integrato nella versione specifica con base (92x59mm).*

*DX54 disponibile in versione 24V o con alimentatore integrato nel corpo 220-240V e in 3 altezze (h.70mm, h.170mm, h.510mm); per installazione su superfici solide nella versione con basetta o nel terreno la versione con picchetto.*





# Dx Ø54 Stem Spike h.70

10° | 26° | 52°



Available finishes:



**Light Source** power led  
**Supply** 24V / 220-240V  
**Dimmer** only 24V (PWM)  
**CRI** ≥80  
**IP rating** IP65  
**Electrical Class** II, III  
**Application** ground  
**Diffuser** transparent glass

**Power** 24V 5,8Wled -6,3We  
 220-240V 5,8Wled - 6,9We  
**Led Colour temp.** 2700K / 3000K



		fascio	lm	aluminium	bronze	black	green
2700K 5,8Wled 6,3We	24V III	▲ 10°with honeycomb	243	900432576	900432579	900432577	9004325716
		▲ 26°with honeycomb	251	900432116	900432119	900432117	9004321116
		▲ 52°with honeycomb	135	900432146	900432149	900432147	9004321416
		▲ 10°without honeycomb	405	900432586	900432589	900432587	9004325816
		▲ 26°without honeycomb	432	900432306	900432309	900432307	9004323016
		▲ 52°without honeycomb	409	900432336	900432339	900432337	9004323316

		fascio	lm	aluminium	bronze	black	green
3000K 5,8Wled 6,3We	24V III	▲ 10°with honeycomb	253	900412576	900412579	900412577	9004125716
		▲ 26°with honeycomb	264	900412116	900412119	900412117	9004121116
		▲ 52°with honeycomb	142	900412146	900412149	900412147	9004121416
		▲ 10°without honeycomb	422	900412586	900412589	900412587	9004125816
		▲ 26°without honeycomb	455	900412306	900412309	900412307	9004123016
		▲ 52°without honeycomb	431	900412336	900412339	900412337	9004123316

		fascio	lm	aluminium	bronze	black	green
2700K 5,8Wled 6,9We	220-240V	▲ 10°with honeycomb	243	900431576	900431579	900431577	9004315716
		▲ 26°with honeycomb	251	900431026	900431029	900431027	9004310216
		▲ 52°with honeycomb	135	900431056	900431059	900431057	9004310516
		▲ 10°without honeycomb	405	900431586	900431589	900431587	9004315816
		▲ 26°without honeycomb	432	900431366	900431369	900431367	9004313616
		▲ 52°without honeycomb	409	900431396	900431399	900431397	9004313916

		fascio	lm	aluminium	bronze	black	green
3000K 5,8Wled 6,9We	220-240V	▲ 10°with honeycomb	253	900411576	900411579	900411577	9004115716
		▲ 26°with honeycomb	264	900411026	900411029	900411027	9004110216
		▲ 52°with honeycomb	142	900411056	900411059	900411057	9004110516
		▲ 10°without honeycomb	422	900411586	900411589	900411587	9004115816
		▲ 26°without honeycomb	455	900411366	900411369	900411367	9004113616
		▲ 52°without honeycomb	431	900411396	900411399	900411397	9004113916

# Dx Ø54 Stem Spike h.170

10° | 26° | 52°

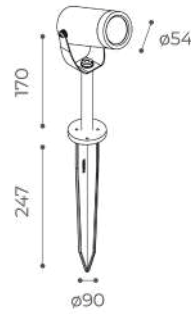

Available finishes:



**Light Source** power led  
**Supply** 24V / 220-240V  
**Dimmer** only 24V (PWM)  
**CRI** ≥80  
**IP rating** IP65  
**Electrical Class** II, III  
**Application** ground  
**Diffuser** transparent glass

**Power** 24V 5,8Wled -6,3We  
 220-240V 5,8Wled - 6,9We  
**Led Colour temp.** 2700K / 3000K



		fascio	lm	aluminium	bronze	black	green
2700K 5,8Wled 6,3We	24V III	▲ 10°with honeycomb	243	900432596	900432599	900432597	9004325916
		▲ 26°with honeycomb	251	900432126	900432129	900432127	9004321216
		▲ 52°with honeycomb	135	900432156	900432159	900432157	9004321516
		▲ 10°without honeycomb	405	900432606	900432609	900432607	9004326016
		▲ 26°without honeycomb	432	900432316	900432319	900432317	9004323116
		▲ 52°without honeycomb	409	900432346	900432349	900432347	9004323416
		fascio	lm	aluminium	bronze	black	green
3000K 5,8Wled 6,3We	24V III	▲ 10°with honeycomb	253	900412596	900412599	900412597	9004125916
		▲ 26°with honeycomb	264	900412126	900412129	900412127	9004121216
		▲ 52°with honeycomb	142	900412156	900412159	900412157	9004121516
		▲ 10°without honeycomb	422	900412606	900412609	900412607	9004126016
		▲ 26°without honeycomb	455	900412316	900412319	900412317	9004123116
		▲ 52°without honeycomb	431	900412346	900412349	900412347	9004123416
		fascio	lm	aluminium	bronze	black	green
2700K 5,8Wled 6,9We	220-240V	▲ 10°with honeycomb	243	900431596	900431599	900431597	9004315916
		▲ 26°with honeycomb	251	900431036	900431039	900431037	9004310316
		▲ 52°with honeycomb	135	900431066	900431069	900431067	9004310616
		▲ 10°without honeycomb	405	900431606	900431609	900431607	9004316016
		▲ 26°without honeycomb	432	900431376	900431379	900431377	9004313716
		▲ 52°without honeycomb	409	900431406	900431409	900431407	9004314016
		fascio	lm	aluminium	bronze	black	green
3000K 5,8Wled 6,9We	220-240V	▲ 10°with honeycomb	253	900411596	900411599	900411597	9004115916
		▲ 26°with honeycomb	264	900411036	900411039	900411037	9004110316
		▲ 52°with honeycomb	142	900411066	900411069	900411067	9004110616
		▲ 10°without honeycomb	422	900411606	900411609	900411607	9004116016
		▲ 26°without honeycomb	455	900411376	900411379	900411377	9004113716
		▲ 52°without honeycomb	431	900411406	900411409	900411407	9004114016







# Dx Ø54 Stem Spike h.510

10° | 26° | 52°

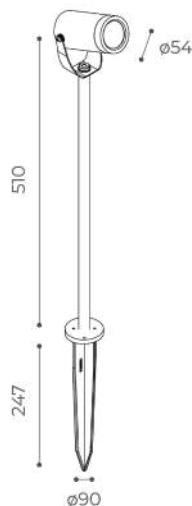

Available finishes:



**Light Source** power led  
**Supply** 24V / 220-240V  
**Dimmer** only 24V (PWM)  
**CRI** ≥80  
**IP rating** IP65  
**Electrical Class** II, III  
**Application** ground  
**Diffuser** transparent glass

**Power** 24V 5,8Wled -6,3We  
 220-240V 5,8Wled - 6,9We  
**Led Colour temp.** 2700K / 3000K



		fascio	lm	aluminium	bronze	black	green
2700K 5,8Wled 6,3We	24V III	▲ 10°with honeycomb	243	900432616	900432619	900432617	9004326116
		▲ 26°with honeycomb	251	900432136	900432139	900432137	9004321316
		▲ 52°with honeycomb	135	900432166	900432169	900432167	9004321616
		▲ 10°without honeycomb	405	900432626	900432629	900432627	9004326216
		▲ 26°without honeycomb	432	900432326	900432329	900432327	9004323216
		▲ 52°without honeycomb	409	900432356	900432359	900432357	9004323516
3000K 5,8Wled 6,3We	24V III	▲ 10°with honeycomb	253	900412616	900412619	900412617	9004126116
		▲ 26°with honeycomb	264	900412136	900412139	900412137	9004121316
		▲ 52°with honeycomb	142	900412166	900412169	900412167	9004121616
		▲ 10°without honeycomb	422	900412626	900412629	900412627	9004126216
		▲ 26°without honeycomb	455	900412326	900412329	900412327	9004123216
		▲ 52°without honeycomb	431	900412356	900412359	900412357	9004123516
2700K 5,8Wled 6,9We	220-240V	▲ 10°with honeycomb	243	900431616	900431619	900431617	9004316116
		▲ 26°with honeycomb	251	900431046	900431049	900431047	9004310416
		▲ 52°with honeycomb	135	900431076	900431079	900431077	9004310716
		▲ 10°without honeycomb	405	900431626	900431629	900431627	9004316216
		▲ 26°without honeycomb	432	900431386	900431389	900431387	9004313816
		▲ 52°without honeycomb	409	900431426	900431429	900431427	9004314216
3000K 5,8Wled 6,9We	220-240V	▲ 10°with honeycomb	253	900411616	900411619	900411617	9004116116
		▲ 26°with honeycomb	264	900411046	900411049	900411047	9004110416
		▲ 52°with honeycomb	142	900411076	900411079	900411077	9004110716
		▲ 10°without honeycomb	422	900411626	900411629	900411627	9004116216
		▲ 26°without honeycomb	455	900411386	900411389	900411387	9004113816
		▲ 52°without honeycomb	431	900411426	900411429	900411427	9004114216



## ACCESSORIES

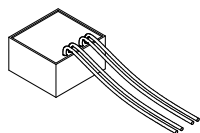

Power supply 8V 110-2240V IP54  
44x46x26mm

code **9037**

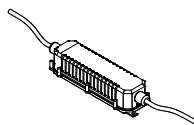

Power supply 24V DC 70W IP67  
267x79x52mm

code **9049**

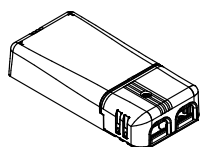

Power supply 24V 16Watt IP20  
118x52x26mm

code **9006**

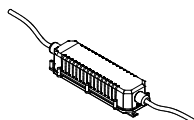

Power supply 24V DC 150W IP67  
267x79x52mm

code **9057**

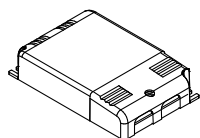

Power supply 24V 20Watt IP20  
103x67x21mm

code **9007**

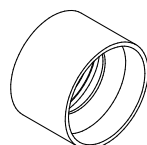

Tube Frame  
Ø54x35mm  
colour **Black**

code **90157**

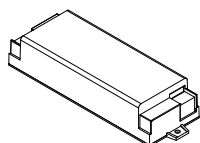

Power supply 24V 50Watt IP20  
190x60x36mm

code **9008**

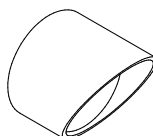

Eyelid Frame  
Ø54x50mm  
colour **Black**

code **90167**

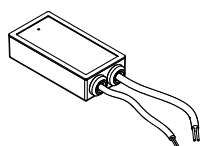

Power supply 16W 110-240V IP65  
125x61x31mm

code **9059**

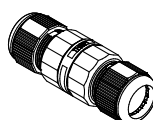

2 way - 3 poles terminal block IP68  
Ø23x66mm

code **9004**

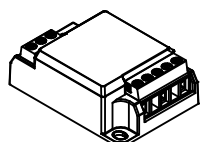

SPD CL.1 12KV 320V UC max  
40x57x20mm

code **9058**

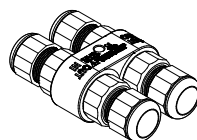

3-4 way - 4 poles terminal block IP68  
53x26x82mm

code **9005**

## ACCESSORIES:

code **9037 / 9006 / 9007 / 9008 / 9059 / 9049 / 9057 / 9058 / 90157 / 90167 / 9004 / 9005**